



RB20-LT



Voltage: 12.8V | Capacity: 20 Ah | Energy: 256 Wh

LITHIUM IRON PHOSPHATE BATTERY **LiFePO4**

| ELECTRICAL SPECIFICATIONS | |
|---------------------------------------|------------------|
| Nominal Voltage | 12.8 V |
| Nominal Capacity | 20 Ah |
| Resistance | ≤45 mΩ @ 50% SOC |
| Efficiency | 99% |
| Self Discharge | <3% per Month |
| Maximum Batteries Connected in Series | 1 (Single Use) |

| DISCHARGE SPECIFICATIONS | |
|--|----------------------------------|
| Maximum Continuous Discharge Current | 20 A |
| Peak Discharge Current | 40 A (7.5 s ±2.5 s) |
| Discharge Over-Current Protection | 50 A ±8 A (32 ±8 ms) |
| Recommended Low Voltage Disconnect | 11.0 V |
| Discharge Under-Voltage Protection | 8.0 V (2.0 ±0.08 vpc) (20 ±8 ms) |
| Reconnect Voltage | 9.04 V (2.26 ±0.34 vpc) |
| Short Circuit Protection Response Time | 100-600 μs |

| TEMPERATURE SPECIFICATIONS | |
|--|-----------------------------|
| Discharge Temperature | -4 to 140 °F (-20 to 60 °C) |
| Charge Temperature* | -4 to 113 °F (-20 to 45 °C) |
| Recommended Storage Temperature | 23 to 95 °F (-5 to 35 °C) |
| BMS High Temperature Cut-Off - Discharge | 185 °F (85 °C) |
| BMS High Temperature Cut-Off - Charge | 140 °F (60 °C) |
| Reconnect Temperature | 122 °F (50 °C) |

*Refer to charge currents below 32°F (0°C)

| MECHANICAL SPECIFICATIONS | |
|---------------------------|---------------------------------------|
| Dimensions (L x W x H) | 7.1 x 3.0 x 6.7" 181 x 76 x 169 mm |
| Weight | 6.6 lbs (3 kg) |
| Terminal Type | M6 x 1 x 12mm |
| Terminal Torque | 35 - 44 in-lbs (4 - 5 N-m) |
| Case Material | ABS |
| Enclosure Protection | IP66 |
| Cell Type - Chemistry | Cylindrical - LiFePO ₄ |

| CHARGE SPECIFICATIONS | |
|-----------------------------------|------------------------------------|
| Recommended Charge Current | 1 A - 10 A |
| Maximum Continuous Charge Current | 20 A |
| Recommended Charge Voltage | 14.2 V - 14.6 V |
| BMS Charge Voltage Cut-Off | 15.6 V (3.9 ±0.025 vpc) (1 ±0.3 s) |
| Reconnect Voltage | 14.6 V (3.8 ±0.050 vpc) |
| Balancing Voltage | 14.4 V (3.6 ±0.025 vpc) |

| HEATING ELEMENT SPECIFICATIONS | |
|--------------------------------|----------------------------|
| Heating Temperature Range | -4 to 50 °F (-20 to 10 °C) |
| Heating Time | Approximately 1 hr @ 3 A |

| COMPLIANCE SPECIFICATIONS | |
|---------------------------|---|
| Certifications | UN38.3, UKCA & CE (battery) UL1642 (cells) (File# MH64523) IEC62133 (cells) |
| Shipping Classification | UN 3480, CLASS 9 |

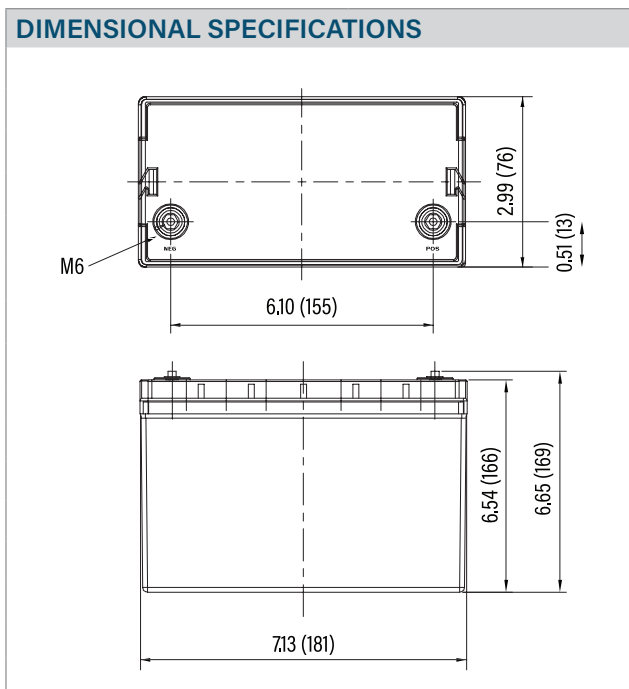



RB20-LT

IEEE/UL Battery
Sizing by
MooreU
610-952-6067
www.mooreu.com

Voltage: 12.8V | Capacity: 20 Ah | Energy: 256 Wh

LITHIUM IRON PHOSPHATE BATTERY **LiFePO4**

TYPICAL LITHIUM IRON PHOSPHATE CHARACTERISTICS*

DISCHARGE VOLTAGE CHARACTERISTICS AT VARIOUS RATES
25°C (77°F)

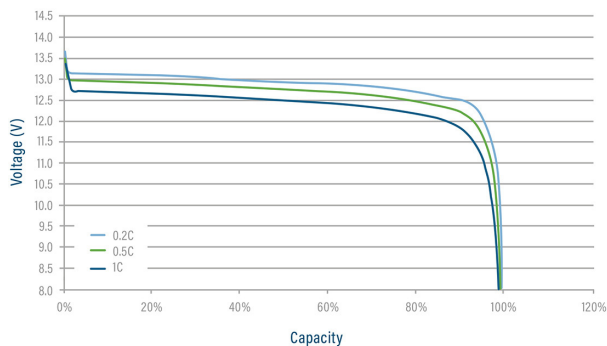

DISCHARGE VOLTAGE CHARACTERISTICS AT VARIOUS TEMPERATURES
DISCHARGE 1C

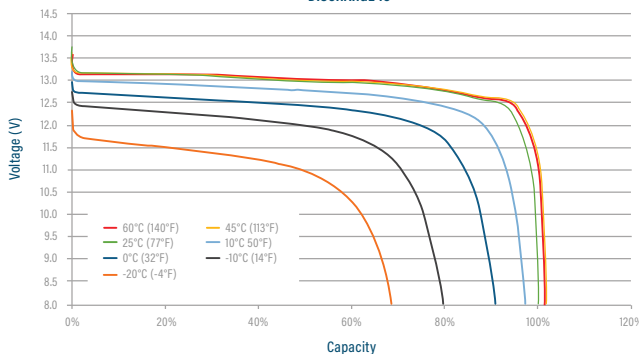

CHARGE VOLTAGE CHARACTERISTICS AT VARIOUS RATES
CHARGE 0.2C

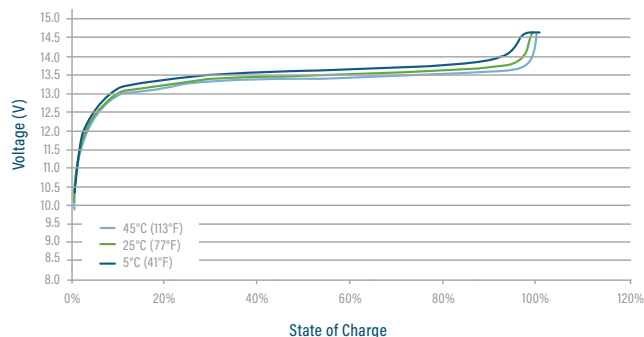

CHARGE VOLTAGE AND STATE OF CHARGE (SOC)
CHARGE 0.2C @ 25°C (77°F)

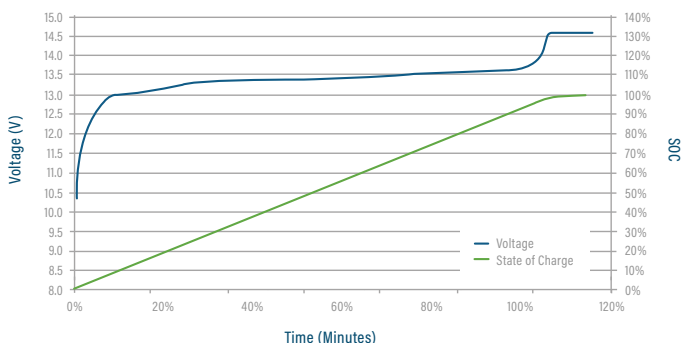

CYCLE LIFE VS. DEPTH OF DISCHARGE (DOD) AT 80%
DISCHARGE 0.5C/CHARGE 0.5C @ 25°C (77°F)

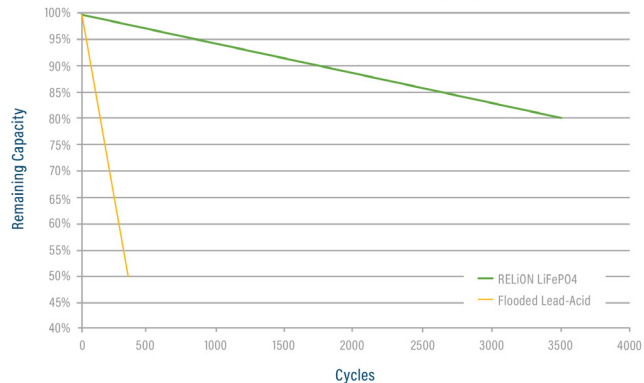

CAPACITY OF RELiON LiFePO4 vs. LEAD ACID
at VARIOUS RATES OF DISCHARGE

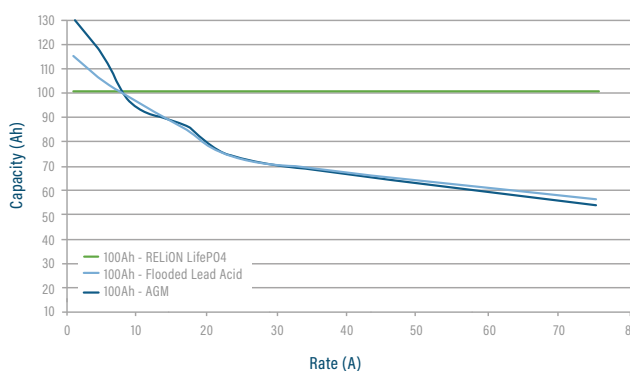

*Performance between applications and batteries may vary. All results should be independently verified by customer.

